

Accessibility guide

Trott Park Neighbourhood Centre



Trott Park Neighbourhood Centre (TPNC) is a vibrant and inclusive community hub. We believe in fostering connections, providing an inclusive and accessible space for community engagement, and supporting various programs and services for all individuals. This guide covers some accessibility details to ensure that everyone can enjoy our facilities, programs, and services at TPNC.

Trott Park Neighbourhood Centre Location

34 Hessing Crescent Trott Park 5158

Working Hours

Monday to Friday, 9 am to 4 pm.
Hours may vary for events.

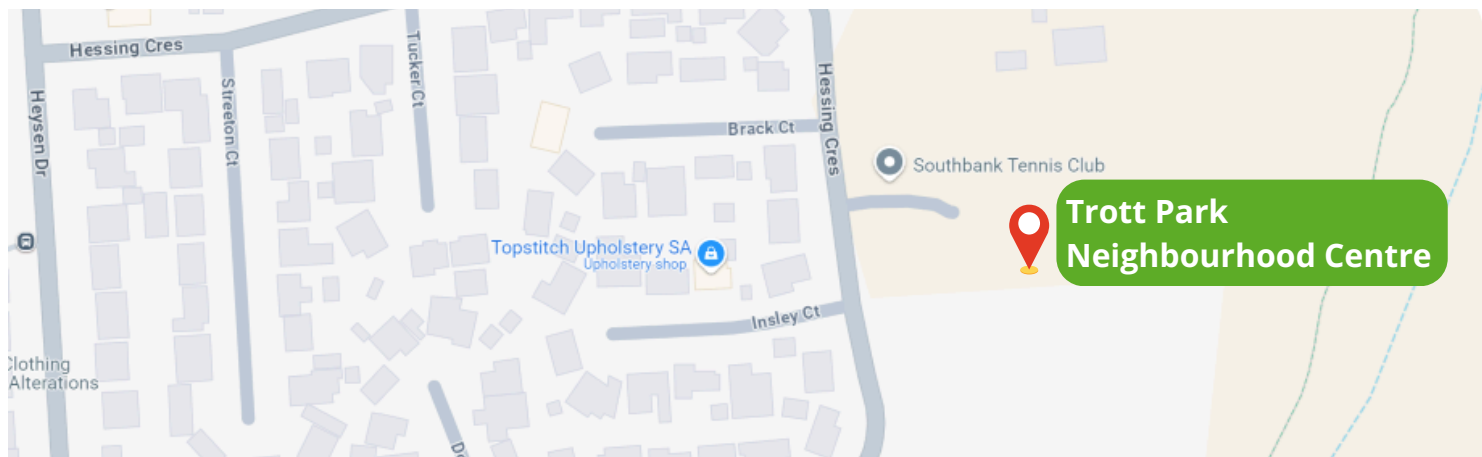

Contact

For any bookings or queries, please contact us:



Email: communityhubs@marion.sa.gov.au



Phone: 8375 6827

We also look forward to seeing you in person!

Pets Welcome

A water fountain is in the playground near the pizza oven. Dog bags are behind the blue bin by the centre's front access carpark.



Wear and Bring

Please feel free to wear and bring whatever makes you comfortable.

Footwear tip:

The onsite parking and inside areas are flat, but the green space outside can be uneven, so comfortable shoes might help!



Parking

Onsite free parking: Two clearly marked accessible car parks and 40 on-site parks available at the front area of the main entrance.

On-street parking: Free and unlimited parking on Hessing Cres, Brack Ct, or Insley Ct. No parking in yellow restriction lines.

Public Transport

Bus: There are several bus stops along Heysen Dr. Stop 54A Heysen Dr - West side and Stop 54A Heysen Dr - East side are the closest, with a 550m walking distance to TPNC. Only bus route 682 stops at these two stops.

Taxi: Drop-off point for taxis is right in front of the TPNC main building, next to the accessible parking spaces.

Train: The closest train station, Hallett Cove Beach, is 5km away from TPNC and not ideal for walking. You can take SEAFORD or NOARLUNGA line, get off at Hallett Cove Beach station, and then take bus 682 to Stop 54A Heysen Dr - east side.



Stop 54A Heysen Dr - east side is the nearest one!



The surrounding area is very hilly, so walking from the bus stops may take longer than usual.



Entrances and Exits

Entry to TPNC is via the automatic door at the main entrance. All entrances and exits are wheelchair accessible. TPNC is a single-floor building, so no lifts are required.



Toilets and Baby Change Room

Toilets, including an accessible one with grab bars, accessible sinks, shower facilities, and a baby change room are near the main entrance inside the TPNC building, available during working hours: Monday to Friday, 9 am to 4 pm.

Public toilets:

2 male/female toilets and 2 unisex/accessible toilets are open 24/7, located just before the northern entrance to the Southland (Community) Tennis Club, opposite the tennis courts from where our NhC is located.



Food and Drink



Coffee, tea, and chilled/hot water are available in the kitchen to your right as you enter the main entrance past the reception.



Programs and Events

At TPNC, programs and events are designed to be inclusive and accessible to everyone, catering to diverse needs and interests. Find more information in the program guide, brochures and flyers available at reception. Please feel free to contact us via phone or email for more details.

Read Program Guide online:

www.marion.sa.gov.au/venues-and-facilities/neighbourhood-centres/programs



Evacuation Plan

Accessible evacuation routes are clearly marked and posted on the walls throughout the neighbourhood centre.



EVACUATION LAYOUT

TROTT PARK NEIGHBOURHOOD CENTRE - 34 HESSING CRESCENT TROTT PARK

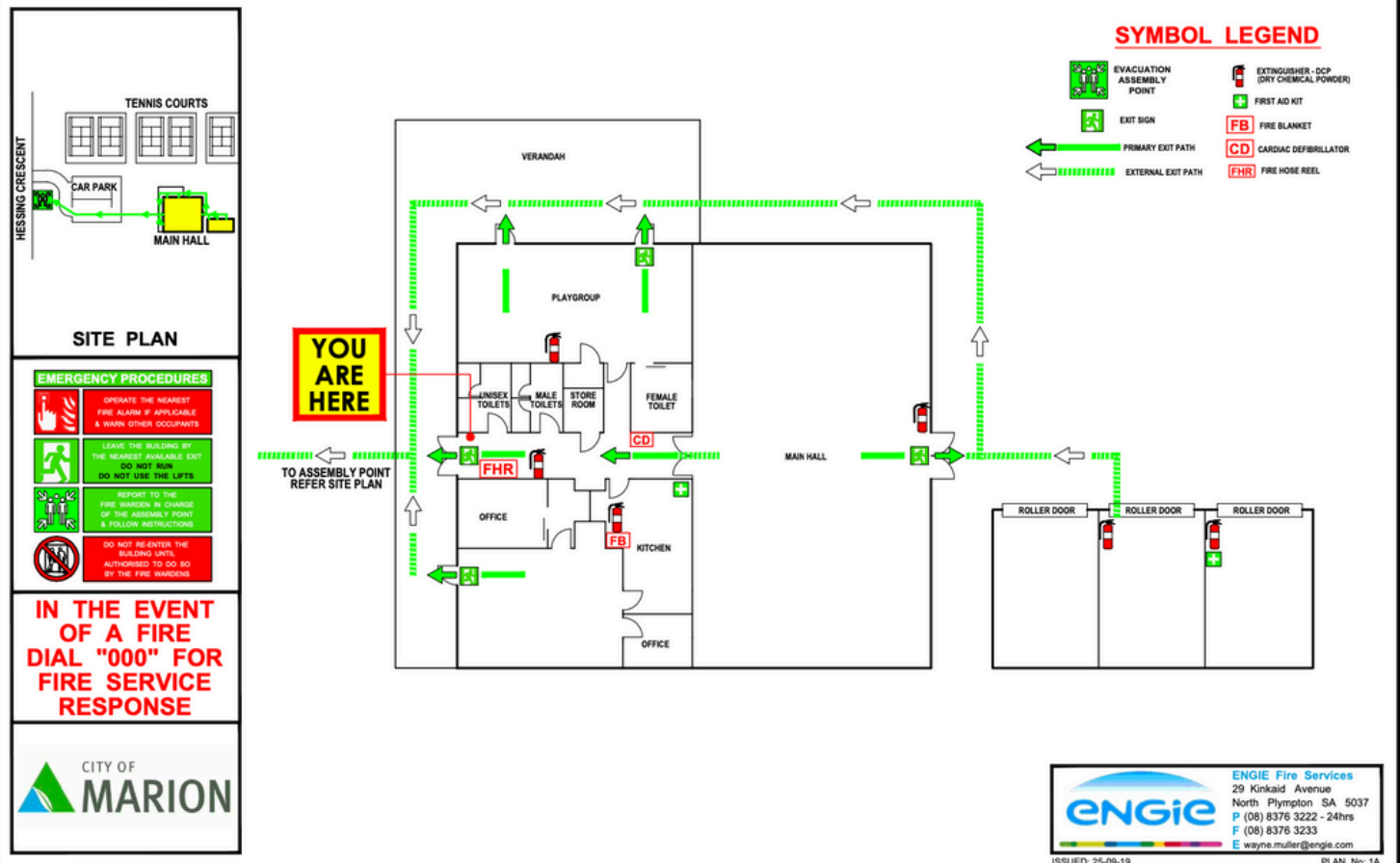

Our new playground is now open!

Location: Hessing Crescent, right next to our NhC building.

Opening hours: 24/7

Playground suitability: 0-12 years

Facilities:

- A tunnel
- 2 slides
- 3 swings
- Musical play element
- Playground fencing
- Shade - trees
- Bark chip softfall
- Rubber softfall
- Giant chess
- Climbing and rope play
- Rock and wood play items



Connect with nature at Trott Park reserves.



Friendly reminder: The area is hilly, so please take care while enjoying the fresh air.



We love your feedback! Let us know about your thoughts!

Via email: communityhubs@marion.sa.gov.au

or submit an anonymous Feedback Form online