

Community Information

MITCHELL STREET RESERVE

SEAVIEW DOWNS

Natural Landscaping Upgrade

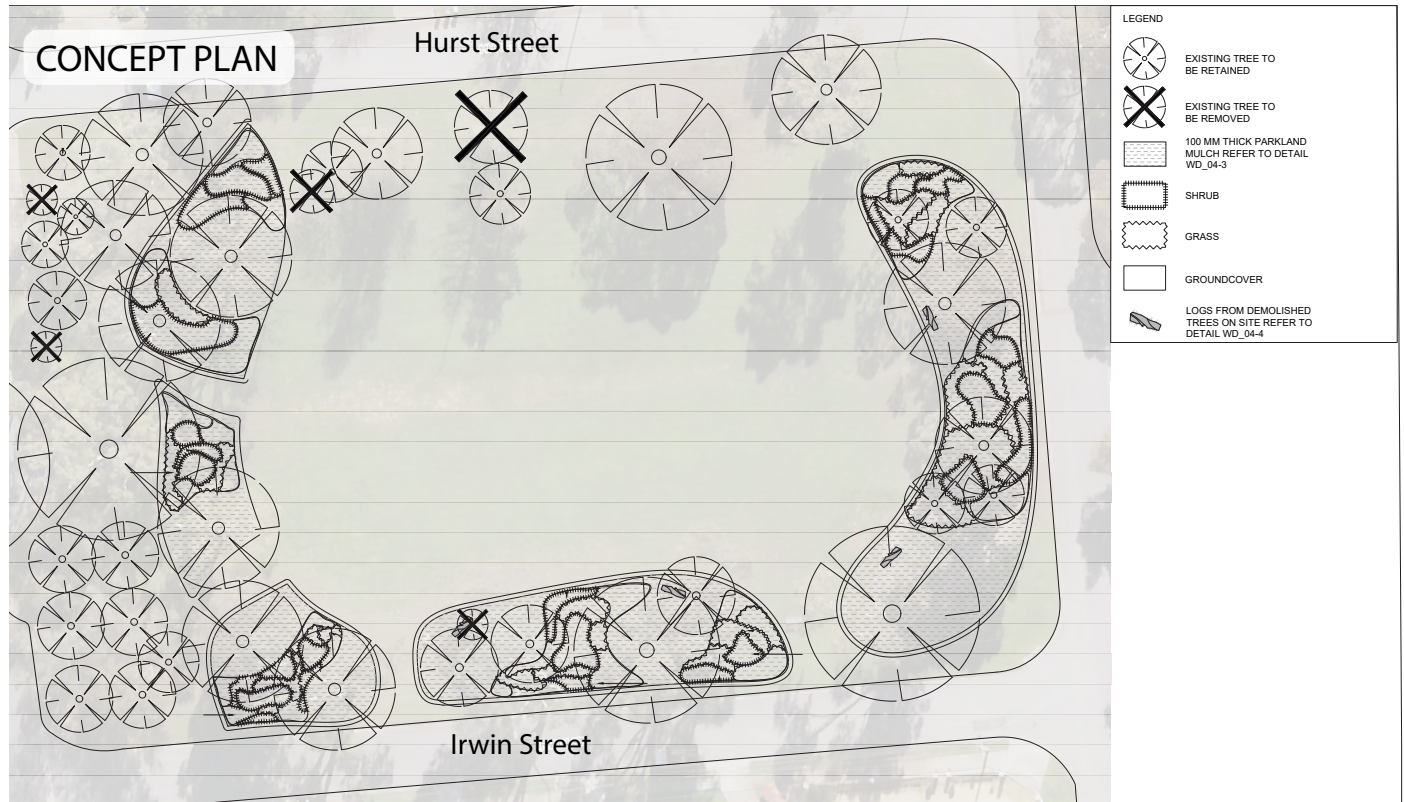

The concept plan can be viewed on line at www.marion.sa.gov.au/mitchell-street-reserve

Council is working to improve the appearance of unirrigated areas of its reserves so they can be enjoyed by the community.

This is part of an ongoing plan to create places for people to play while saving our most precious resource – water.

At Mitchell Street Reserve you will see:

- The border of the reserve enhanced through landscaping
- More than 2,000 native seedlings planted
- Mulch added around trees

To help keep you safe, and to encourage revegetation, dead and pest trees will be removed. This will involve specialist staff drilling holes in the base of five trees and poisoning them using a special herbicide. This process will minimise the risk of damage to adjacent vegetation.

Poisoning the pest trees before removing them prevents regrowth.

The centre of the reserve will be irrigated, this work is planned for the 20/21 financial year.

Frequently Asked Questions

Why natural landscaping?

Natural landscapes provide open space for general enhancement of the natural environment and passive recreation. These spaces support and facilitate biodiversity through providing habitat, shelter and resources and improving landscapes without additional water use.

Natural Landscaping Guidelines developed in 2017 provide options for unirrigated areas to improve biodiversity, green amenity, engagement with nature and urban cooling.

Why are we removing trees?

Trees identified for removal are pest trees that prevent regeneration of the landscape.

Five trees will be removed.

These trees need to be poisoned before being cut down to ensure they do not regrow.

How will the trees be removed?

Identified trees will be drilled and filled with herbicide. This will take 6- 10 weeks to take effect. The herbicide will not cause damage to other vegetation on site.

What will be done with the timber and branches of the tree?

Foliage and smaller branches will be processed by a wood chipper into mulch. Larger parts of the tree will be retained on site for seating and natural habitats.

What will replace the trees?

No further trees will be planted. Over 2,000 seedlings will be planted and native grasses will be protected. Good quality mulch will be spread around existing trees and plantings.

When will these works happen?

Herbicide will be applied immediately and will take up to 10 weeks to take effect.

Landscaping will be complete before the end of June. Winter is the most appropriate time to plant the seedlings.

What will happen to the rest of the reserve?

The centre of the reserve will be irrigated to provide a green open area. A new irrigation system will be installed in the 20/21 financial year.

How many reserves is this happening at?

Three reserves are being landscaped

- Pavana Reserve
- Mitchell Street Reserve
- Alpine Road Reserve

For further information please call Open Space Operations on 8375 6600

